

## ZL-2001 *Zwei L* Stainless Steel Handle

### Features

- Superior "Zwei L Finish" - *Zwei L* represents the very pinnacle of ultra-premium Japanese hardware design. The contrasting bands of mirror finish and lustrous satin on a faceted profile give a jewel like finish that highlights and enhances any industrial design

### Notes

- When installing to thin sheet metal or acrylic sheet, mounting surface may not be horizontal and the sheet may warp. Please check with actual item.

### Parts Included

- Truss head screw M4×30 (SUS)

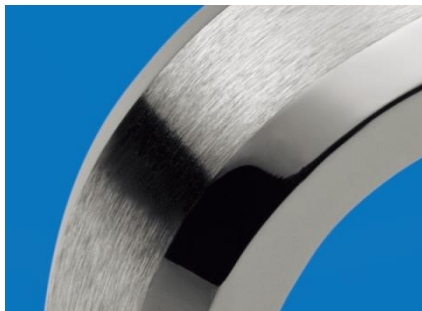

Superior finishing

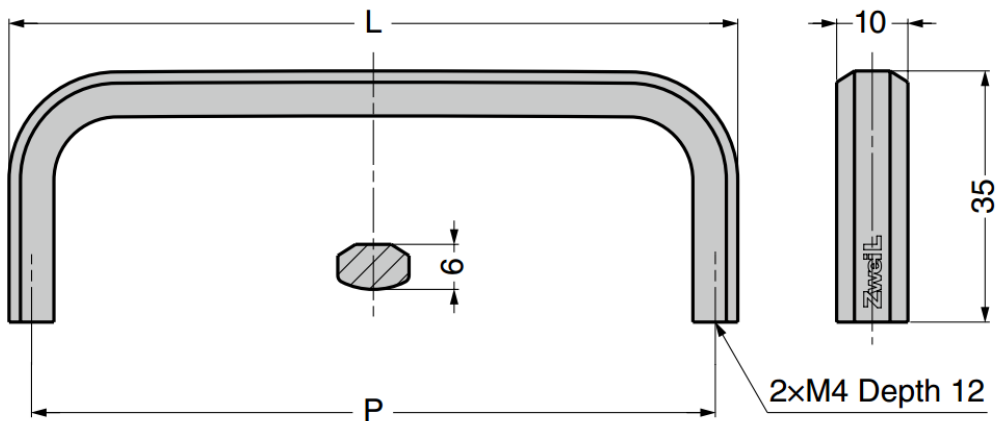

Part No.	Material	Finish	L	P
ZL-2001-32	Stainless Steel 316	Zwei L Finish	38	32
ZL-2001-64			70	64
ZL-2001-96			102	96
ZL-2001-128			134	128
ZL-2001-160			166	160
ZL-2001-192			198	192
ZL-2001-256			262	256

## ZL-2301 *Zwei L* Stainless Steel Handle Bracket

### Features

- Bracket for installing handle ZL-2001 and ZL-2002 on glass doors
- For glass doors of 4, 5 and 6 mm thickness

#### ① ZL glass mounting bracket $\phi 16$

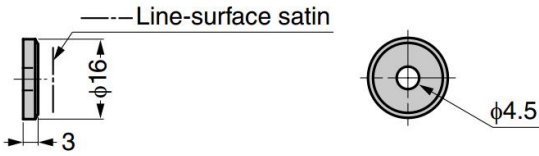

#### ② ZL glass mounting bracket $\phi 25$

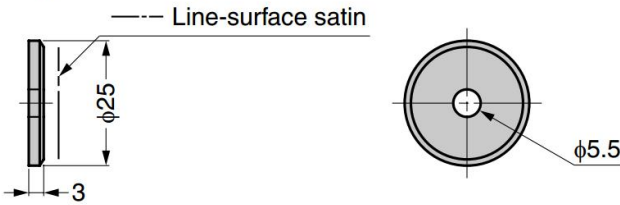

#### ③ Gasket for ZL glass mounting bracket $\phi 14$

#### ④ Gasket for ZL glass mounting bracket $\phi 20$

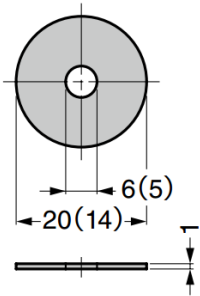
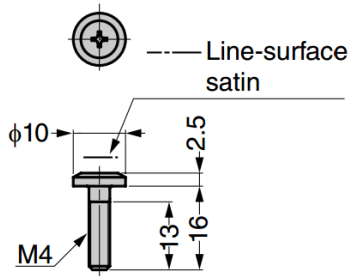

Figure above shows ④.  
Dimensions in ( ) are for ③.

#### ⑤ ZL countersunk head screw M4x16



Glass processing hole  
 $\phi 5$  (glass thickness 4, 5)  
 $\phi 6$  (glass thickness 6)

#### ⑥ ZL countersunk head screw M5x16

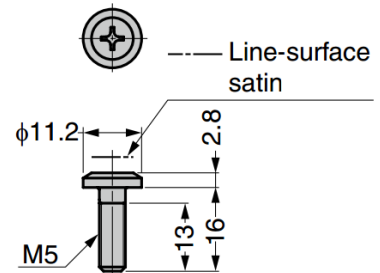

Glass processing hole  $\phi 6$

### Bracket set for ZL-2001 $\phi 16$ (with screw)

No.	Part Name	Material	Finish / Colour
①	Bracket ( $\phi 16$ )	Stainless Steel (SUS316)	Zwei L Finish
③	Gasket ( $\phi 14$ )	Elastomer (TPE)	Clear
⑤	Truss Head Screw M4 x 16	Stainless Steel	Zwei L Finish

### Bracket set for ZL-2002 $\phi 25$ (with screw)

No.	Part Name	Material	Finish / Colour
②	Bracket ( $\phi 25$ )	Stainless Steel (SUS316)	Zwei L Finish
③	Gasket ( $\phi 14$ )	Elastomer (TPE)	Clear
④	Gasket ( $\phi 20$ )		
⑥	Truss Head Screw M5 x 16	Stainless Steel	Zwei L Finish

Part No.

ZL-2301-2016

Part No.

ZL-2301-2025